

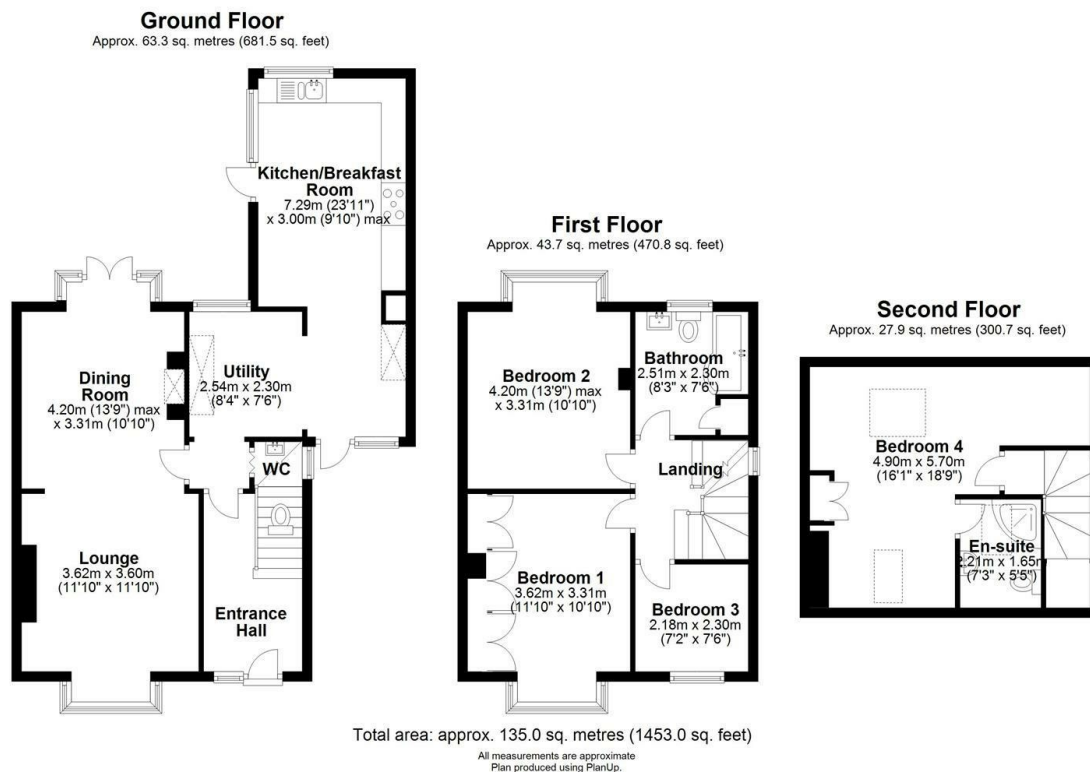

48 Mowson Crescent, Worrall, Sheffield, South Yorkshire, S35 0AG

Asking Price £395,000

- SUPERB FOUR BEDROOM FAMILY HOME
- THREE FIRST FLOOR BEDROOMS
- OFF ROAD PARKING FOR TWO CARS
- COUNCIL TAX BAND D - £2,053.83 pa
- LOUNGE DINING ROOM
- LARGE FAMILY BATHROOM
- TIERED PRIVATE REAR GARDEN
- SPACIOUS KITCHEN BREAKFAST ROOM
- FANTASTIC SECOND FLOOR SUITE
- LEASEHOLD WITH 734 YEARS REMAINING



Directions

Viewings

Viewings by arrangement only. Call 0114 2299 060 to make an appointment.

Council Tax Band

D

EPC Rating:

D

Energy Efficiency Rating		
	Current	Potential
Very energy efficient - lower running costs		
(92-plus) A		
(81-91) B		80
(69-80) C		
(55-68) D	64	
(39-54) E		
(21-38) F		
(1-20) G		
Not energy efficient - higher running costs		
England & Wales	EU Directive 2002/91/EC	